

THE ORKIT PH-II



*Home is a starting place
for love, hope and dreams*

Developed by:
ORCHID REALTORS



DAY VIEW







FLAT	TYPE	SALEABLE AREA sq.ft
A	3BHK	1290.33
B	2BHK	879.80
C	3BHK	1266.06
D	3BHK	1311.73
E	3BHK	1404.91

TYPICAL FLOOR PLAN

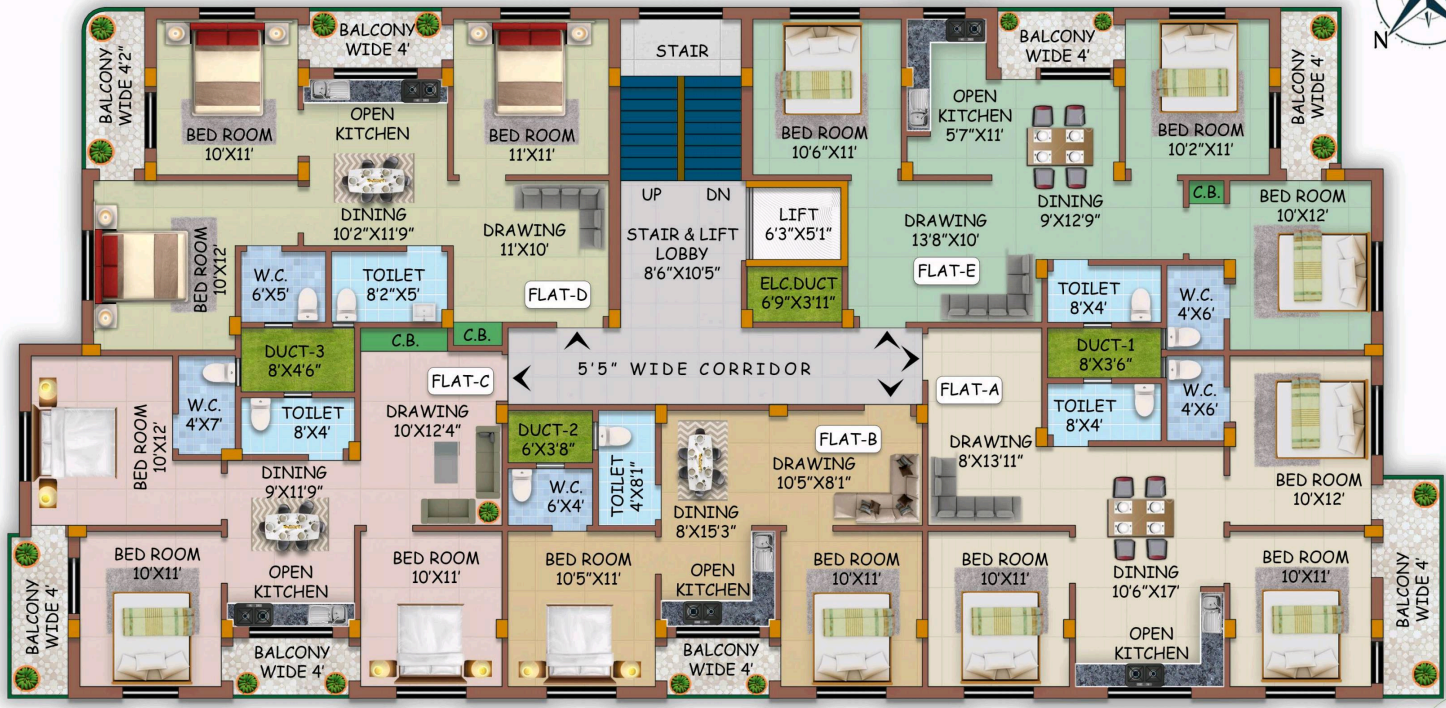

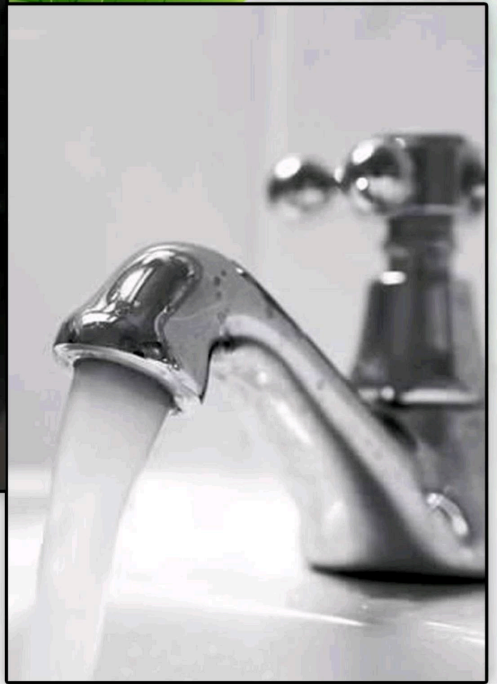

AMENITIES

- 24HRS SECURITY
- INTERCOM FACILITY
- LIFT
- 24HRS WATER SUPPLY
- 24HRS POWER SUPPLY

SPECIFICATION

STRUCTURE :

Earthquake resistance
RCC frame structures.

BALCONY:

Vitrified tiles flooring.
Electrical points for
pleasure usage.

DOORS & WINDOWS:

Doors: Laminated flush
doors.

Windows: Aluminium
sliding with glass panel.

KITCHEN:

Vitrified tiles flooring. Granite
platform & stainless sink. Dado
upto 2.5 ft on wall.

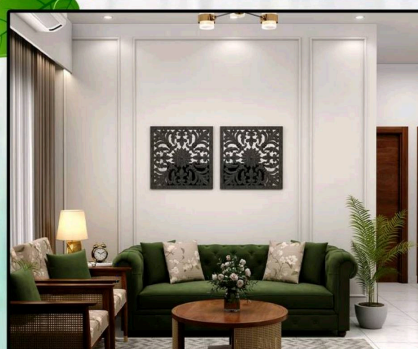

Location Map

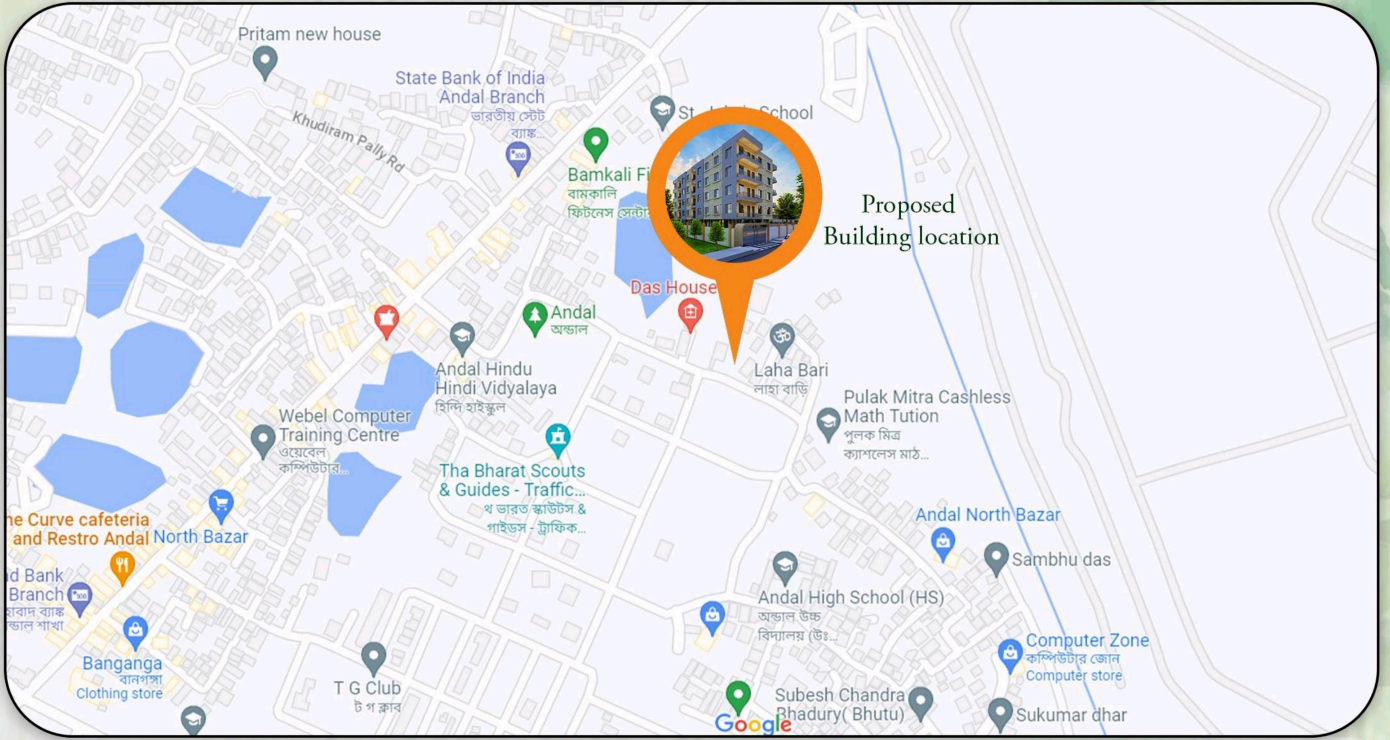

School - 1.5km



Bank - 1km



Hospital - 2.3km



Bus Stand - 1.5km



Andal Market - 1.1km



Railway Station - 1.5km



Airport - 4km

SITE ADDRESS: School para, Andal North Bazar, Andal.

OFFICE ADDRESS: Andal more, G.T. Road Andal,
Near - Bajaj Showroom

CONTACT US: 7699001200

EMAIL: orchidrealtors22@gmail.com

Designed By



www.gidsbengal.com

Notes: This brochure is only a conceptual presentation of the project and not a legal offering.
The promoters receive the right to alter and make changes in elevation, specifications and plans are deemed fit.